

ADJUSTMENT INSTRUCTIONS

for DELTA 'P' OVERLOAD VALVE 28446-S

This instruction sheet provides information for service personnel to replace the existing Delta 'P' Overload Valve and adjust. Use this sheet in conjunction with the appropriate winch Parts, Operation and Maintenance Manual for the model on which the replacement valve will be used.

ADJUSTMENT INSTRUCTIONS

Removal of Existing Valve



- Shut off main air supply to winch and bleed air lines before conducting any service work on the winch or controls.

Refer to appropriate winch Parts Operation and Maintenance Manual for the model on which the replacement valve will be used.

1. Properly mark all hose connections on existing valve before removing from winch.
2. Disconnect and remove fitting and hose connections to valve.
3. Remove capscrews attaching valve to winch. The place of attachment may vary depending upon winch model.
4. Properly discard existing Delta 'P' Valve.

Installation and Adjustment of Replacement Valve

1. Attach fittings and marked hose connections to valve. Temporarily attach valve to winch so adjustment screw is fully accessible to make adjustments.



- Do not use utility ratings for Man Rider applications unless using winch in a non-Man Riding capacity.

NOTICE

- The approximate rated load to be lifted is needed before adjustments to valve can be made.
- It is recommended to adjust valve so winch is just able to lift rated load.

Refer to Dwg. MHP2441 and MHP2442 on page 1.

1. Remove Plug (571) from valve assembly.
2. Loosen jam nut (577).
3. To lift heavier load, turn adjustment screw (576) in a clockwise direction.
4. To decrease load turn adjustment screw (576) in a counterclockwise direction.

5. Hold adjustment screw (576) in place while tightening jam nut (577).
6. Re-install plug (571).
7. Test and make final adjustments when winch is installed in desired application.
8. Install valve to winch using existing capscrews after desired adjustments have been completed.

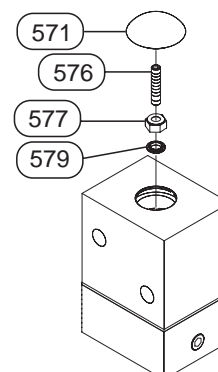

(Dwg. MHP2441)

Item No.	Description of Part	Total Qty	Part Number
571	Plug	1	71387211
576	Adjustment Screw	1	71386809
577	Jam Nut	1	71386817
579	Diaphragm	1	28443

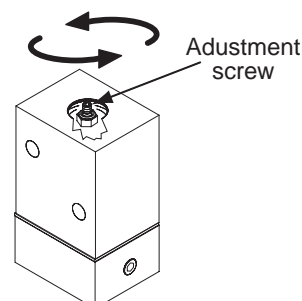

(Dwg. MHP2442)

Form MHD56253

Edition 1

April 2002

71403661

© 2002 Ingersoll-Rand Company



United States Office Locations

For Order Entry and Order Status

**Ingersoll-Rand
Global Logistics**
P.O. Box 618
510 Hester Drive
White House, TN 37188
Phone: (615) 474-8665
Fax: (615) 672-0854

Technical Support

Ingersoll-Rand
P.O. Box 24046
2724 Sixth Avenue South
Seattle, WA 98124-0046
Phone: (866) 273-FAST(3278)
Fax: (206) 624-6265

Web Site:

www.irco.com

Regional Sales Offices

Annandale, NJ
P.O. Box 970
1467 Route 31 South
Annandale, NJ 08801
Phone: (908) 238-7000
Fax: (908) 238-7048

Detroit, MI
1872 Enterprise Drive
Rochester, MI 48309
Phone: (248) 293-5700
Fax: (248) 293-5800

International Office Locations

Offices and distributors in principal cities throughout the world. Contact the nearest **Ingersoll-Rand** office for the name and address of the distributor in your country or write/fax to:

Canada

**National Sales Office
Regional Warehouse
Toronto, Ontario**
51 Worcester Road
Rexdale, Ontario
M9W 4K2
Phone: (416) 213-4500
Fax: (416) 213-4510
Order Desk
Fax: (416) 213-4506

Latin America Operations

Ingersoll-Rand
730 N.W. 107 Avenue
Suite 300
Miami, FL 33172-3107
Phone: (305) 559-0500
Fax: (305) 222-0864

Europe, Middle East and Africa

**Ingersoll-Rand
Douai Operations**
111, avenue Roger Salengro
59450 Sin Le Noble, France
Phone: (33) 3-27-93-08-08
Fax: (33) 3-27-93-08-00

Asia Pacific Operations Ingersoll-Rand Asia Pacific

42 Benoi Road
Jurong 629903
Singapore
Phone: (65) 861 1555
Fax: (65) 861 0317

Russia

Ingersoll-Rand
Kuznetsky Most 21/5
Entrance 3
Moscow 103895 Russia
Phone: (7) 501 923 9134
Fax: (7) 501 924 4625

Australia

Ingersoll-Rand Aust
1 Hartnett Drive
Seaford, Vic 3198
Australia
Phone: 613 95541642
Fax: 613 95541607